

Features

- Compact gas valves for OEM applications
- 2-way normally closed operation
- For control of commercial ovens and gas generators
- Valves available with optional 1/8" NPT upstream and downstream pipe taps with plugs for routine testing

Fluid: Fuel Gas

Construction

Valve Parts in Contact with Fluids	
Body	Aluminum
Seals and Disc	LT NBR
Core Tube	305 Stainless Steel
Core Guide	POM
Rider Ring	PTFE
Core and Plugnut	430F Stainless Steel
Springs	302 Stainless Steel
Shading Coil	Copper
Pipe Plug	Zinc-Plated Steel

Electrical

Standard Coil and Class of Insulation	Watt Rating and Power Consumption				Ambient Temp. °F	Spare Coil Family					
	DC Watts	AC				Open Frame				Watertight	
		Watts	VA Holding	VA Inrush		Spade		Leads		AC	DC
						AC	DC	AC	DC		
F	-	11.8	21.7	55.2	-40 to 175	218410	-	064982	-	-	-
F	11.2	-	-	-	-40 to 140	-	218855	-	066611	-	-
F	-	10.1	25	70	-40 to 175	-	-	-	-	238610	-
F	11.6	-	-	-	-40 to 140	-	-	-	-	-	238710

Standard Voltages: 24, 120, 240 volts AC, 60 Hz (or 110, 220 volts AC, 50 Hz); 12, 24 volts DC.

Solenoid Enclosures

Open Frame: Either spade terminals or 18" leads.

Watertight: Molded epoxy Type 4 and 4X with 1/2" metal conduit hub and 18" leads.

Valve Opening/ Closing Time: Less than 1 second

Options: Mounting bracket, Coil with 72" leads.

How to Order

8 0 4 0 A 0 2 1	L 0	4 0 0	F 3
Base Catalog Number Refer to the Specifications Section	Electrical Interface	Valve Construction	Voltage
	L0 Open Frame Lead (18")	400 LT NBR disc, NBR seals w/o mounting bracket	AC
	L7 Open Frame Lead (72")	000 LT NBR disc, NBR seals with mounting bracket	F4 24/60
	0D Open Frame Spade		F0 120/60, 110/50
	C0 Watertight RHIII 1/2" Conduit Lead (18")		F6 240/60, 220/50
	C7 Watertight RHIII 1/2" Conduit Lead (72")		DC
			F3 12V
			F1 24V

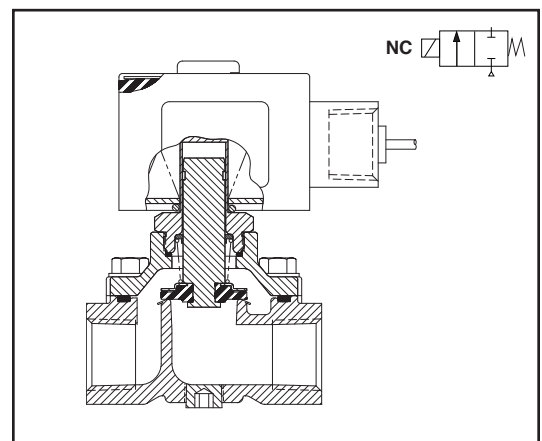
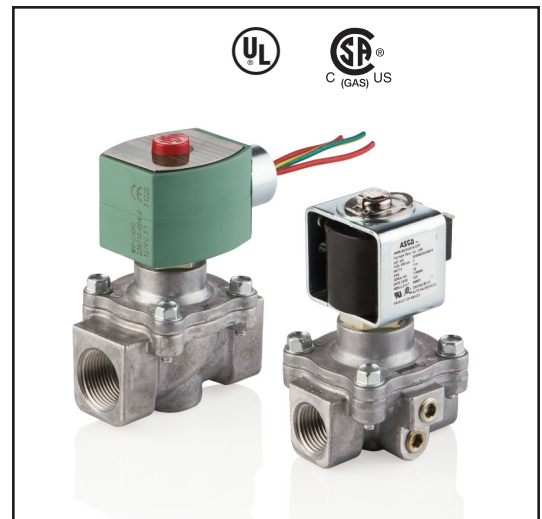

Approvals

Open Frame: UL recognized component to standard 429 "Electrically Operated Valves", Guide Y10Z2, File MP618 Safety Valves.

Watertight: UL listed to standard 429 "Electrically Operated Valve", Guide Y10Z File MP618 Safety Valves.

Open Frame/Watertight: CSA Certified to:

- 1) Standard C22.2 No. 139 "Electrically Operated Valves", File 010381
- 2) Automatic Gas Valves ANSI Z21.21 CSA 6.5 C/I, File 112872

Specifications (English units)

Pipe Size (in)	Orifice Size (in)	Cv Flow Factor	Gas Capacity		Operating Pressure Differential (psi)		Max. Fluid Temp. °F		Base Catalog Number	Const. Ref.	Agency		Wattage		Approx. Shipping Weight (lbs)
			Btu/hr. ①	Btu/hr. ②	Min.	Max.	AC	DC			UL	CSA	AC	DC	
Open Frame															
3/8	3/4	3.9	210,000	500,000	0	2	175	-	8040A021	1	○	○	11.8	-	1.5
1/2	3/4	5.4	291,000	693,000	0	2	175	-	8040A022	1	○	○	11.8	-	1.5
3/4	3/4	9.5	512,000	1,219,000	0	2	175	-	8040A023	2	○	○	11.8	-	1.5
3/8	3/4	3.9	210,000	500,000	0	2	175	-	8040A121④	1	○	○	11.8	-	1.5
1/2	3/4	5.4	291,000	693,000	0	2	175	-	8040A122④	1	○	○	11.8	-	1.5
3/4	3/4	9.5	512,000	1,219,000	0	2	175	-	8040A123④	2	○	○	11.8	-	1.5
3/8	3/4	3.6	195,000	-	0	1 ③	-	125	8040A021	1	○	○	-	11.2	1.5
1/2	3/4	4.5	244,000	-	0	1 ③	-	125	8040A022	1	○	○	-	11.2	1.5
3/4	3/4	6.6	358,000	-	0	1 ③	-	125	8040A023	2	○	○	-	11.2	1.5
3/8	3/4	3.6	195,000	-	0	1 ③	-	125	8040A121④	1	○	○	-	11.2	1.5
1/2	3/4	4.5	244,000	-	0	1 ③	-	125	8040A122④	1	○	○	-	11.2	1.5
3/4	3/4	6.6	358,000	-	0	1 ③	-	125	8040A123④	2	○	○	-	11.2	1.5
Watertight															
3/8	3/4	3.9	210,000	500,000	0	2	175	-	8040G021	3	○	○	10.1	-	1.8
1/2	3/4	5.4	291,000	693,000	0	2	175	-	8040G022	3	○	○	10.1	-	1.8
3/4	3/4	9.5	512,000	1,219,000	0	2	175	-	8040G023	4	○	○	10.1	-	1.8
3/8	3/4	3.9	210,000	500,000	0	2	175	-	8040G121④	3	○	○	10.1	-	1.8
1/2	3/4	5.4	291,000	693,000	0	2	175	-	8040G122④	3	○	○	10.1	-	1.8
3/4	3/4	9.5	512,000	1,219,000	0	2	175	-	8040G123④	4	○	○	10.1	-	1.8
3/8	3/4	3.6	195,000	-	0	1 ③	-	125	8040G021	3	○	○	-	11.6	1.8
1/2	3/4	4.5	244,000	-	0	1 ③	-	125	8040G022	3	○	○	-	11.6	1.8
3/4	3/4	6.6	358,000	-	0	1 ③	-	125	8040G023	4	○	○	-	11.6	1.8
3/8	3/4	3.6	195,000	-	0	1 ③	-	125	8040G121④	3	○	○	-	11.6	1.8
1/2	3/4	4.5	244,000	-	0	1 ③	-	125	8040G122④	3	○	○	-	11.6	1.8
3/4	3/4	6.6	358,000	-	0	1 ③	-	125	8040G123④	4	○	○	-	11.6	1.8

○ = Safety Shutoff Valve
 ① 1" W.C. Drop @ 2" W.C. Inlet Pressure, 1,000 Btu/cu.ft. or more, 0.64 Specific Gravity Gas.
 ② Per CSA 6.5 @ 25% inlet pressure/ 10% pressure drop
 ③ 1/2 psi for CSA
 ④ No pipe taps in body

Specifications (Metric units)

Pipe Size (in)	Orifice Size (mm)	Kv Flow (m ³ /hr)	Gas Capacity		Operating Pressure Differential (bar)		Max. Fluid Temp. °C		Base Catalog Number	Const. Ref.	Agency		Wattage		Approx. Shipping Weight (kgs)
			Btu/hr. ①	Btu/hr. ②	Min.	Max.	AC	DC			UL	CSA	AC	DC	
Open Frame															
3/8	19	3.3	210,000	500,000	0	0.13	79	-	8040A021	1	○	○	11.8	-	0.7
1/2	19	4.6	291,000	693,000	0	0.13	79	-	8040A022	1	○	○	11.8	-	0.7
3/4	19	8.1	512,000	1,219,000	0	0.13	79	-	8040A023	2	○	○	11.8	-	0.7
3/8	19	3.3	210,000	500,000	0	0.13	79	-	8040A121④	1	○	○	11.8	-	0.7
1/2	19	4.6	291,000	693,000	0	0.13	79	-	8040A122④	1	○	○	11.8	-	0.7
3/4	19	8.1	512,000	1,219,000	0	0.13	79	-	8040A123④	2	○	○	11.8	-	0.7
3/8	19	3.1	195,000	-	0	0.068③	-	52	8040A021	1	○	○	-	11.2	0.7
1/2	19	3.9	244,000	-	0	0.068③	-	52	8040A022	1	○	○	-	11.2	0.7
3/4	19	5.7	358,000	-	0	0.068③	-	52	8040A023	2	○	○	-	11.2	0.7
3/8	19	3.1	195,000	-	0	0.068③	-	52	8040A121④	1	○	○	-	11.2	0.7
1/2	19	3.9	244,000	-	0	0.068③	-	52	8040A122④	1	○	○	-	11.2	0.7
3/4	19	5.7	358,000	-	0	0.068③	-	52	8040A123④	2	○	○	-	11.2	0.7
Watertight															
3/8	19	3.3	210,000	500,000	0	0.13	79	-	8040G021	3	○	○	10.1	-	0.8
1/2	19	4.6	291,000	693,000	0	0.13	79	-	8040G022	3	○	○	10.1	-	0.8
3/4	19	8.1	512,000	1,219,000	0	0.13	79	-	8040G023	4	○	○	10.1	-	0.8
3/8	19	3.3	210,000	500,000	0	0.13	79	-	8040G121④	3	○	○	10.1	-	0.8
1/2	19	4.6	291,000	693,000	0	0.13	79	-	8040G122④	3	○	○	10.1	-	0.8
3/4	19	8.1	512,000	1,219,000	0	0.13	79	-	8040G123④	4	○	○	10.1	-	0.8
3/8	19	3.1	195,000	-	0	0.068③	-	52	8040G021	3	○	○	-	11.6	0.8
1/2	19	3.9	244,000	-	0	0.068③	-	52	8040G022	3	○	○	-	11.6	0.8
3/4	19	5.7	358,000	-	0	0.068③	-	52	8040G023	4	○	○	-	11.6	0.8
3/8	19	3.1	195,000	-	0	0.068③	-	52	8040G121④	3	○	○	-	11.6	0.8
1/2	19	3.9	244,000	-	0	0.068③	-	52	8040G122④	3	○	○	-	11.6	0.8
3/4	19	5.7	358,000	-	0	0.068③	-	52	8040G123④	4	○	○	-	11.6	0.8

○ = Safety Shutoff Valve

① 1" W.C. Drop @ 2" W.C. Inlet Pressure, 1,000 Btu/cu.ft. or more, 0.64 Specific Gravity Gas.

② Per CSA 6.5 @ 25% inlet pressure/ 10% pressure drop

③ 1/2 psi for CSA

④ No pipe taps in body

Dimensions inches (mm)

Const. Ref.		1	2	3	4
A	in	1.1	1.1	1.1	1.1
	mm	29	29	29	29
B	in	1.7	1.7	3.1	3.1
	mm	43	43	78	78
H	in	4.0	4.4	4	4.4
	mm	101	112	102	112
J	in	0.9	0.9	2.1	2.1
	mm	23	23	52	52
K	in	2.4	2.5	2.4	2.6
	mm	60	65	62	67
L	in	2.8	3.3	2.8	3.3
	mm	70	84	70	84
N	in	2.3	2.6	3.4	3.7
	mm	58	65	87	94
R	in	1.4	1.7	1.4	1.7
	mm	35	42	35	42
P	in	3.4	3.6	3.4	3.6
	mm	86	91	86	91
T	in	1.8	1.8	2	2
	mm	46	46	50	50
W	in	2.5	2.3	2.5	2.3
	mm	63	59	63	59
Pipe Taps		B & C	A & C	B & C	A & C

Mountable in any position (AC)
Must be mounted with solenoid vertical and upright (DC)

Mounting Bracket (All Constructions)

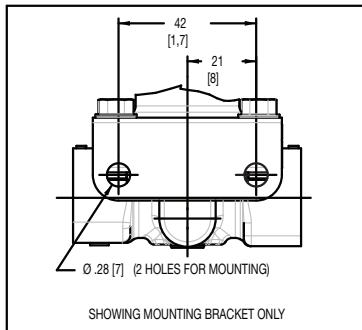

Const. Ref. 1, 2

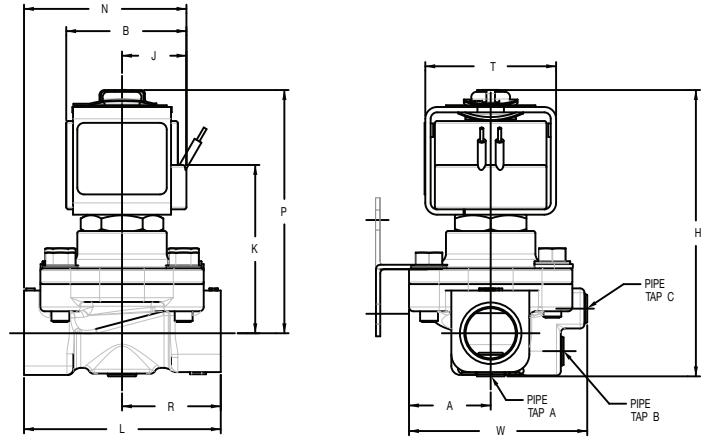

Const. Ref. 3, 4

